

5 Trewin Court Narre Warren VIC

4 2 4

This is a brick veneer house that ticks all the boxes for great family living. Located in a quiet court in Narre Warren, Walking distance to the popular Oatlands Primary School, and easy access to Westfield Fountain Gate Shopping Centre, Parkhill Plaza Shopping Centre, Narre Warren Train Station, Berwick Town Centre, Wilson Botanic Park Berwick, Maramba Primary School, and Timbarra P-9 College , Federation University, Nossal High school, Chisholm Institute TAFE , Monash Health-Casey Hospital, Monash Freeway, princes Hwy and so on.

This expansive four generously sized bedrooms ,2bathrooms with multiple living areas house offers a unique blend of comfort and style, perfect for families or those seeking extra space.

[For full version visit the website](https://www.yere.com.au)

Type : House
Price : \$ 950,000
Land Size : 845 sqm
View : <https://www.yere.com.au/sale/vic/south-east/narre-warren/residential/house/8168017>



Crystal Lin
03 8578 5700



Lin Zhang
03 8578 5700

FLOOR PLAN



SITE PLAN

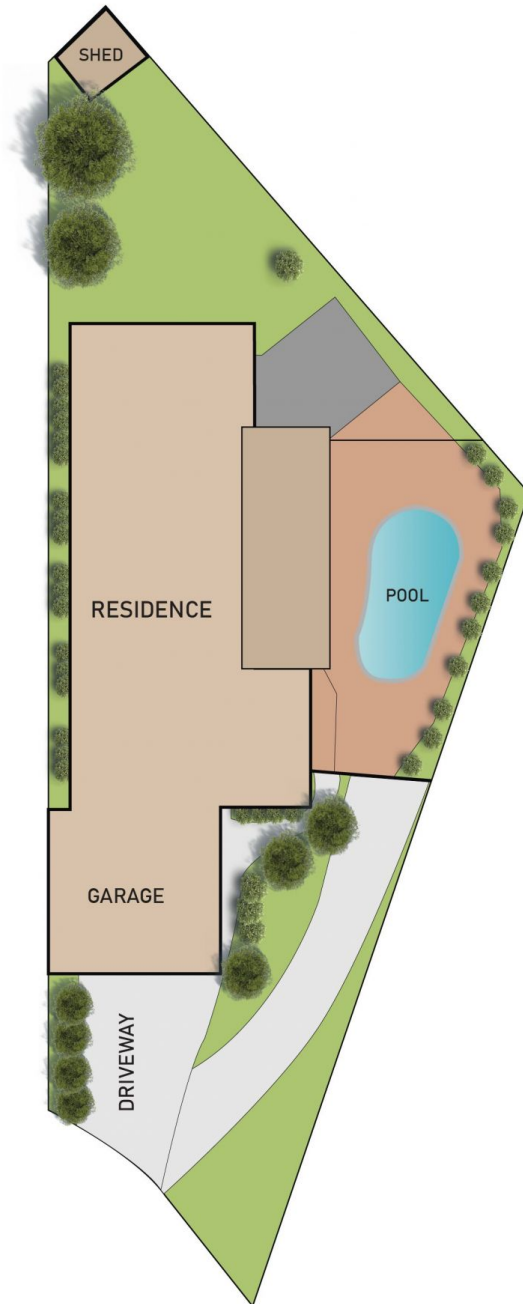

5 TREWIN COURT, NARRE WARREN

FLOOR AND SITE PLAN IS FOR ILLUSTRATIVE PURPOSES ONLY AND NOT TO SCALE. THE VENDOR, AGENCY OR SUPPLIER MAKE NO GUARANTEE, WARRANTY OR REPRESENTATION AS TO THE ACCURACY OF ANY INFORMATION CONTAINED HEREIN AND THE COMPLETENESS OF THE FLOOR PLANNED WILL ACCEPT NO LIABILITY FOR ITS ACCURACY. INTERESTED PARTIES ARE ADVISED TO MAKE THEIR OWN INDEPENDENT ENQUIRIES.